

CYCLONE

MOTORCYCLE SECURITY

PAGING SYSTEM



Instruction Guide



FreyMoto
Industries

© 2006-2008 All Rights Reserved

Ver. 1.3, Apr'08

Thank you for purchasing this CYCLONE Paging System. Please familiarize yourself with the content of this Guide before you begin installing.

⚠ IMPORTANT! *DO NOT INSTALL THIS PAGING SYSTEM YOURSELF UNTIL YOU HAVE SPOKEN TO FREYMOTO IN ADVANCE TO LEARN WHAT IS REQUIRED. SEE THE CYCLONE OWNER'S GUIDE, PAGE 1.*

NOTICE! Although reasonable efforts have been taken to ensure accuracy in this Instruction Guide, Freymoto Industries shall not be held liable for any errors, omissions, property damage, loss or injury resulting from the use of this information.

All product specifications and features are subject to change without notice.

INTRODUCTION

Installation Tips

- **BEFORE INSTALLING THE PAGER ANTENNA UNIT** (see page 5), ensure your **CYCLONE 866F** security system is working properly.
- **DO NOT LOSE OR MISPLACE THE 2 ANTENNAS!** The two antenna parts and two plastic caps are wrapped separately in plastic. You must attach these parts to the Antenna Unit for the system to function.
- The Antenna Unit is not waterproof and should be mounted beneath the seat, in a location where water cannot collect around it. Take care not to mount it where metal surrounds the antenna on all sides as such may limit transmission range.
- Be sure to cover your wiring so it has a factory appearance, and always keep your connections protected from the outside elements.
- No soldering/splicing required for installation.
- There is no need to disconnect power to your bike or power to the **CYCLONE 866F** when installing the pager antenna unit.

Feature Highlights

- Long Range
- 16.7 Million Unique Pager Codes
- Learn Mode for Multiple/Replacement Pagers
- Simple Operation
- Lightweight and Compact Pager with built-in Belt Clip
- Tones/Vibration and Visual LED Notification when 866F siren goes off
- Choice of 3 beep sounds, 3 melody sounds or 3 vibration patterns
- **Pager Battery Low Notification**

When the battery voltage falls to about 2.0v, the pager may refuse to turn on when the ON/OFF button is pressed. If you always hear 2 beeps when pushing the ON/OFF button, the pager is telling you it's time to change the batteries.

INCLUDED ITEMS

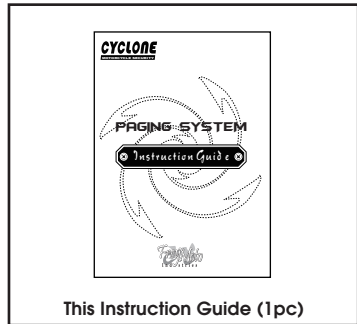
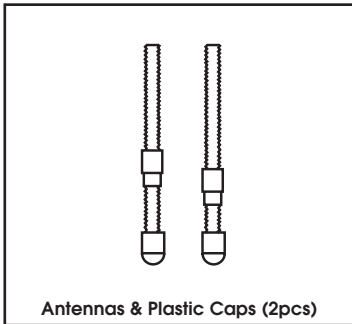
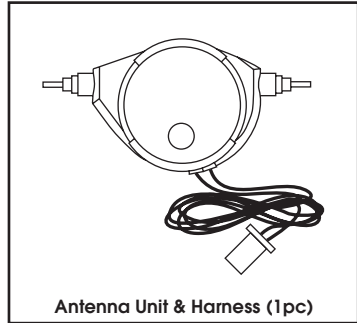
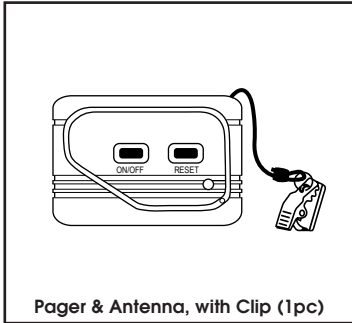

⚠ IMPORTANT! Do not misplace the two Antennas and two Plastic Caps. These cannot be ordered separately and are not covered under warranty if you lose them! You must affix these parts to the Antenna Unit for your Paging System to function properly.

TECHNICAL SPECIFICATIONS

Pager

Operating Voltage:	2.1~3.3Vdc, using two AAA batteries (<i>not included</i>)
Adapter Input:	4.5Vdc (<i>adapter not included</i>)
Battery Life:	18~25 days (<i>when left turned ON</i>)
Standby Current:	2.0mA (<i>when ON</i>)
Alert Current:	70mA (<i>when beeping or vibrating</i>)
Rx Sensitivity:	-106dBm
Operating Temp.:	-10°C to +60°C
Typical Range:	600m / 2,000ft.
Beeper Sound:	75dB (<i>measured 30cm/1ft. from pager</i>)
Dimensions:	70 x 48 x 17 mm (<i>excludes belt clip</i>)

Antenna Unit

Operating Voltage:	12Vdc (<i>fed from the 866F alarm unit</i>)
Peak Current:	40mA (<i>when transmitting</i>)
Standby Current:	none (<i>switched off / not transmitting</i>)
Operating Temp.:	-10°C to +60°C
Transmission Freq.:	433.92MHz
Output Power:	200mW
Modulation:	ASK
Dimensions:	190 x 40 x 18 mm
Harness Length:	2 meters

Cyclone Paging System Part No.: 42042a

FCC ID: LEB20A

ASSEMBLY

To prevent excessive bending while inside the packaging, the two antennas have been removed and are contained in a small plastic bag. You simply need to screw-on both antennas as shown below. *(Keep in mind that you may have to twist firmly as some antennas are a very tight fit.)*

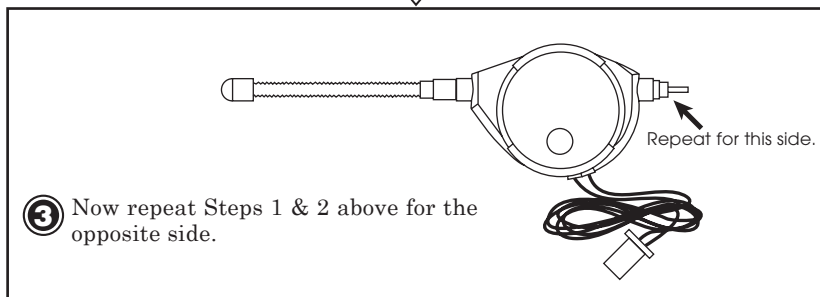
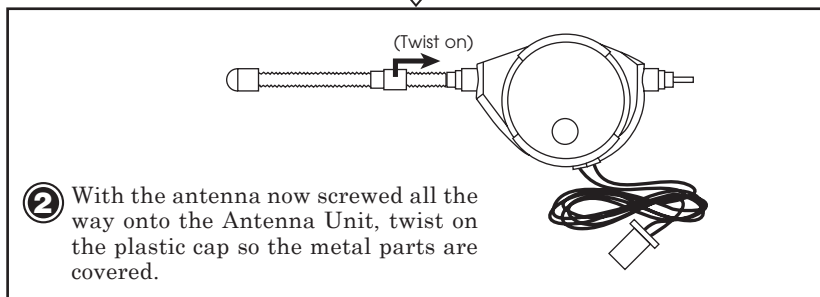
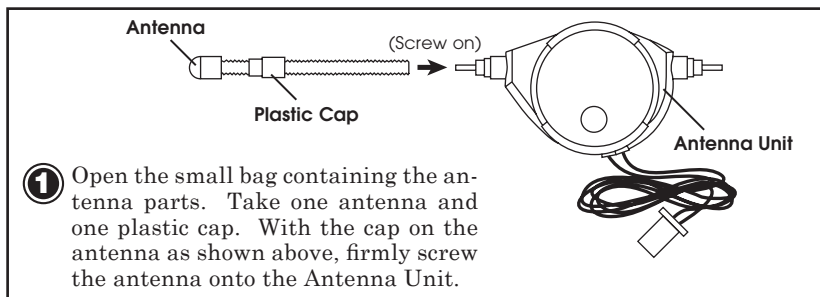

INSTALLATION

1. The Antenna Unit is not waterproof and should be mounted beneath the seat, in a location where water won't pool. Do not mount it where metal surrounds the antenna on all sides as such may limit transmission range. You will use the affixed 2-sided tape to mount the antenna unit in your desired location. **DO NOT MOUNT ON BIKE WITH TAPE YET.**
2. Disarm your Cyclone 866F system.
3. There are 2 wires coming out of the Antenna Unit with a black connector at one end. Plug this black connector into the matching connector on the Cyclone 866, as shown at point **A** in the diagram below.

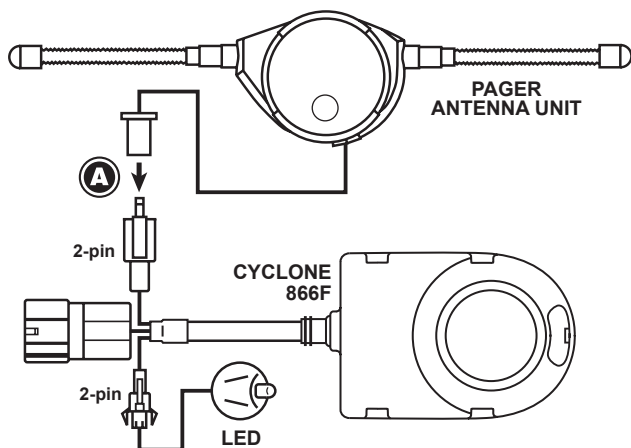

4. Close the seat and arm the 866F.
5. Put batteries in the pager and press the ON/OFF button once. You should hear a long beep. Walk a couple hundred meters (several hundred feet) from the bike. Have someone trigger the alarm by tilting or tapping hard on the bike. You should hear a repeating group of beeps and see the LED flash when the 866F is triggered. If range is bad, consider repositioning the antenna.
6. When satisfied with range, affix antenna unit to the bike with tape.

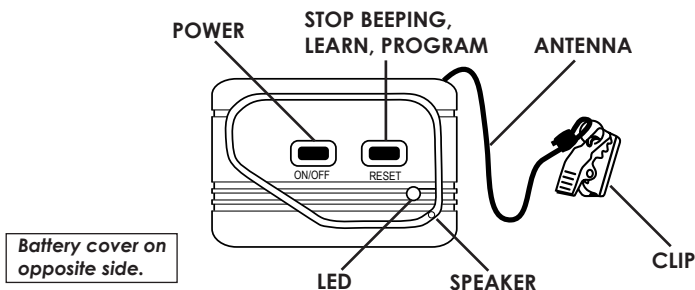

General Operation

POWER. After inserting two AAA batteries, you should hear 2 beeps. Push and release the ON/OFF button and you should then hear a long beep (1 sec.) and feel a short vibration. This indicates the pager power is on and the pager can now receive signals from the bike. Push ON/OFF again and you will hear 2 short beeps to confirm the pager is shut off, drawing no power.

RESET. If Cyclone's full siren goes off while the pager is turned on, the pager will beep and the LED will flash. You can temporarily stop the pager beeping and flashing by *pressing and holding* the RESET button. Soon after you release RESET, the pager will start beeping and flashing again if the siren is still going off. To stop the beeping and flashing without holding down RESET, simply press the ON/OFF button to turn your pager off — you will then hear 2 beeps to confirm your pager is turned off.

 **TIP.** Do not cut or break off the antenna strap leading to the clip. It is fairly strong, but it will break if too much force is applied. Breaking off the antenna will negatively impact pager range. Clip can be attached to pants to ensure pager doesn't fall to the ground.

Learning

Pager Learn Mode is useful if you lose your pager and need a replacement, or if you simply want to have more than one pager.

1. Arm the Cyclone 866F, but do not trigger the siren yet.
2. Turn the pager on and then off. (You should hear 2 beeps when off.)

3. Hold down the RESET button and then press and release the ON/OFF button. You should hear 10 beeps when you release the ON/OFF button. Now release the RESET button.
4. You now have 60 seconds to trigger the Cyclone 866F's siren (which in turn will cause the Antenna Unit to start transmitting).
5. Within the 60 seconds, if the pager receives a valid signal from the Antenna Unit, you will hear another 10 beeps, confirming that the pager unit is now programmed to go off when it receives a signal from your Antenna Unit.

Troubleshooting

PAGER DOESN'T RESPOND WHEN SIREN GOES OFF

- Replace with two fresh AAA batteries.
- Check the antenna unit connection to the 866F and ensure the 866F is functioning properly. Ensure the 2 antennas are connected!
- Test in another location like the countryside to verify if the problem is RF interference. It is unlikely the pager will not respond at all due to interference, unless you are near a large tower-style transmitter or radio operating in the 433MHz band. In this case, the pager will not function until you distance yourself from that RF interference.

WORRIED PAGER BATTERY WILL DIE

- The pager will beep twice each time you push a button when it's time to change the batteries. But you will likely notice the batteries are low before this because the range will shorten as the batteries die.
- Battery life depends on the quality of batteries you use. Modern 1200mAh alkaline AAA batteries should last almost 30 days.
- The pager draws no power when off and battery life will increase as a result.
- Using rechargeable NiMH batteries (not included) is one means of eliminating the need to purchase new alkalines every month. But keep in mind the voltage of NiMH batteries is lower than that of alkalines.

Programming Tones & Vibration

You can program your pager to respond with 1 of 3 different beep tones, or 1 of 3 different melody tones, or 1 of 3 different vibration patterns whenever your Cyclone 866F alarm is triggered (full siren).

1. Turn the Pager off and then on. (You should hear 1 long beep.)
2. Press and hold the RESET button, and then press and release the ON/OFF button. You will then hear 4 beeps.
3. Keep pressing the RESET button. After a couple seconds you should then hear 1 beep. Releasing the RESET button at this point will allow you to select 1 of 3 **beeping tones**. Each of the 3 tones will repeat twice. Press and release the RESET button to select the currently playing beep tone. You will then hear 4 beeps to confirm your selection. Simply trigger the Cyclone siren to activate your pager and hear your selected tone.
4. If you did not release the RESET button in Step-3, then you will hear a 2nd beep in a couple seconds. Releasing the RESET button at this point will allow you to select 1 of 3 **melody tones**. Each of the 3 melodies will repeat twice. Press and release the RESET button to select the currently playing melody tone. You will then hear 4 beeps to confirm your selection. Simply trigger the Cyclone siren to activate your pager and hear your selected tone.
5. If you did not release the RESET button in Step-3 or Step-4, then you will hear a 3rd and final beep in a couple seconds. Releasing the RESET button at this point will allow you to select 1 of 3 **vibration patterns**. Each of the 3 vibration patterns will repeat twice. Press and release the RESET button to select the vibration pattern. You will then hear 4 beeps to confirm your selection. Simply trigger the Cyclone siren to activate your pager and feel your vibration pattern.

⚠ NOTES: *If you never release the RESET button in Steps 3, 4 or 5 above, then the pager will beep 4 times showing that it has exited programming mode. Also, if you release the RESET button in Step-2 above, you will then hear 4 beeps which indicate the pager has exited program mode. Factory default setting is 1 long beep followed by 2 short beeps.*

FCC Statement

This device complies with part 15 of the FCC Rules. Operation is subject to the following two conditions: (1) This device may not cause harmful interference, and (2) this device must accept any interference received, including interference that may cause undesired operation.

This equipment has been tested and found to comply with the limits for a Class B digital device, pursuant to part 15 of the FCC rules. These limits are designed to provide reasonable protection against harmful interference in a residential installation. This equipment generates, uses and can radiate radio frequency energy and, if not installed and used in accordance with the instructions, may cause harmful interference to radio communications

Any changes or modification not expressly approved by the party responsible could void the user's authority to operate the device.

This CYCLONE Paging System has been tested in strict accordance with Japanese QC standards.

www.freymoto.com

FREYMOTO INDUSTRIES

1435 N. McCarthy Rd, Bldg. 12, Appleton, WI 54913 USA
TEL/FAX: 800-374-0933 • EMAIL: sales@freymoto.com

CYCLONE is a trademark of KIRAMEK, Inc.